

This information provided by:



Gross Automation
www.grossautomation.com

Call Toll Free:
800-349-5827

HP SERIES HIMEL DOORLOCK INSTRUCTIONS

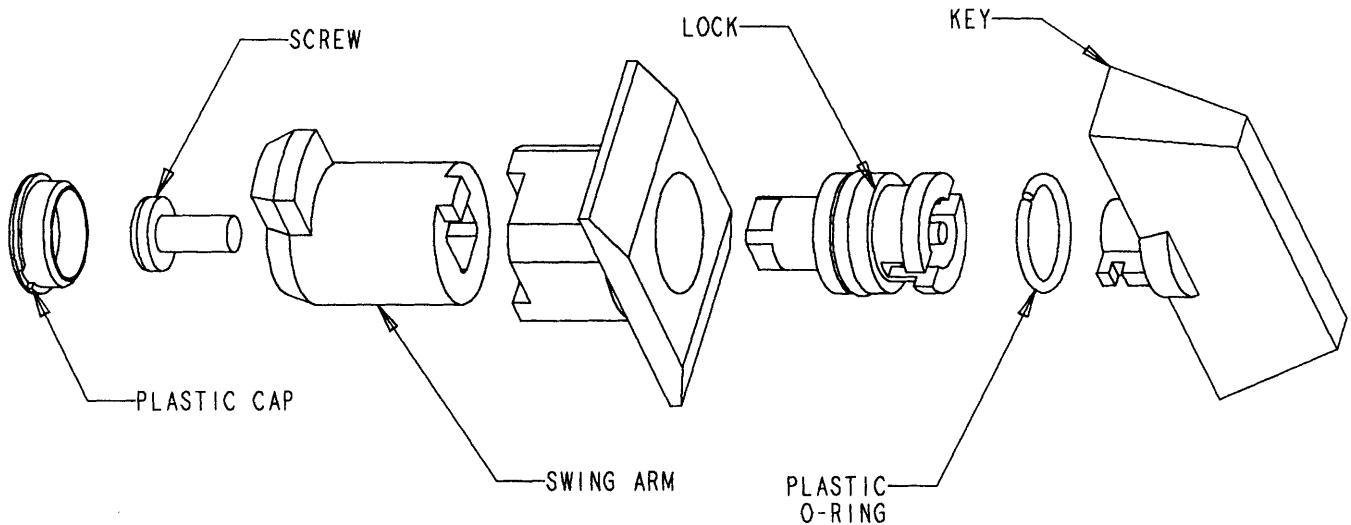

TO ATTACH THE KEY TO THE LOCK FOR THE HP SERIES HIMEL
ENCLOSURES, FOLLOW THE BELOW LISTED INSTRUCTIONS:

1. REMOVE PLASTIC CAP FROM THE BACK OF THE LOCKING MECHANISM WITH A FLAT BLADED SCREWDRIVER.
2. USING SCREWDRIVER, REMOVE THE SCREW FROM INSIDE THE SWING ARM, THEN REMOVE THE ARM.
3. PUSH ON BACK TO EXTEND THE FRONT OF THE LOCK.
4. REMOVE THE PLASTIC O-RING FROM THE FRONT OF THE LOCK.
5. INSERT KEY INTO FRONT OF LOCK, THEN PLACE O-RING AROUND GROOVE.
6. PUSH LOCK BACK INTO PLACE, THEN REPLACE SWING ARM AND SCREW.
7. COMPLETE BY REPLACING PLASTIC CAP.

TITLE	HP SERIES HIMEL DOORLOCK INSTRUCTIONS	DRN DJK	DATE 2-16-98	PART NO: HPRLA
LAMSON & SESSIONS <small>ALL DRAWINGS ARE THE PROPERTY OF LAMSON & SESSIONS AND SHALL NOT BE REPRODUCED IN ANY FORM WITHOUT LAMSON & SESSIONS' APPROVAL AND ARE TO BE PROMPTLY RETURNED UPON REQUEST.</small>	<small>APP. DATE</small> 		<small>DRAWING NO:</small> AC03363	<small>REV.</small>
	<small>Gross Automation (877) 268-3700 - www.carlonsales.com - sales@grossautomation.com</small>			