

Carlton® Residential Slab Floor Box Assembly

The Carlton Residential Slab Floor Box makes installing floor outlets in concrete slabs faster and easier. The box/extension sleeve is designed to be saw-cut to accommodate any concrete floor thickness up to six inches with no leveling required. It features a divider for dual voltage service, and comes with a mud cap to keep out cement during the pour. The solid brass cover has a single hinged door that lies flat when open. The cover accommodates a single electrical outlet (provided) and a low voltage port (data jack not included). It has a light lacquer finish for extra strength and durability in high traffic areas, and is UL scrub water tested.



Features:

- Dual service divider (*included*) to allow dual service in one box.
- Saw-cut to finished concrete pour – No leveling required.
- Single receptacle chamber: 17.25 cu. in.
Data jack chamber: 15.06 cu. in. for easier wiring. (Cubic inches based on 6" box/sleeve depth).
- Pre-assembled Solid brass cover for superior aesthetics and durability. Single electrical receptacle included. **Data jack NOT included.**
- UL and c-UL Listed, UL 514C scrub water tested, and a 2 hour fire classification.

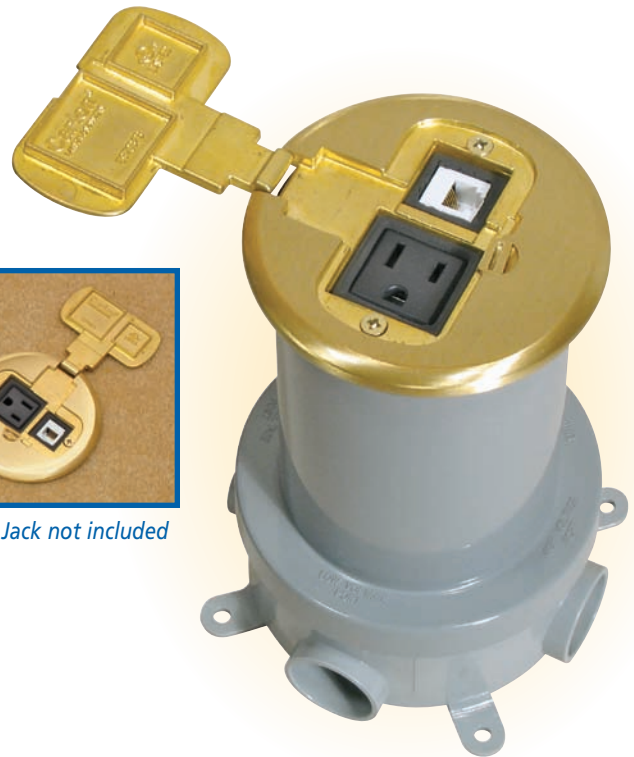

Data Jack not included

Innovative Solutions For Wire and Cable Management.

Specifications

Part Number	Description	Std. Carton Qty.	Std. Carton Wt. (lbs.)
E970CDX	Box w/ 1/2" Hubs	24	12.0
E970CEX	Box w/ 3/4" Hubs	24	11.0
E970CES	Extension Sleeve w/ Mud Cap	24	20.0
E970CEC	Brass Cover Assembly	24	28.0

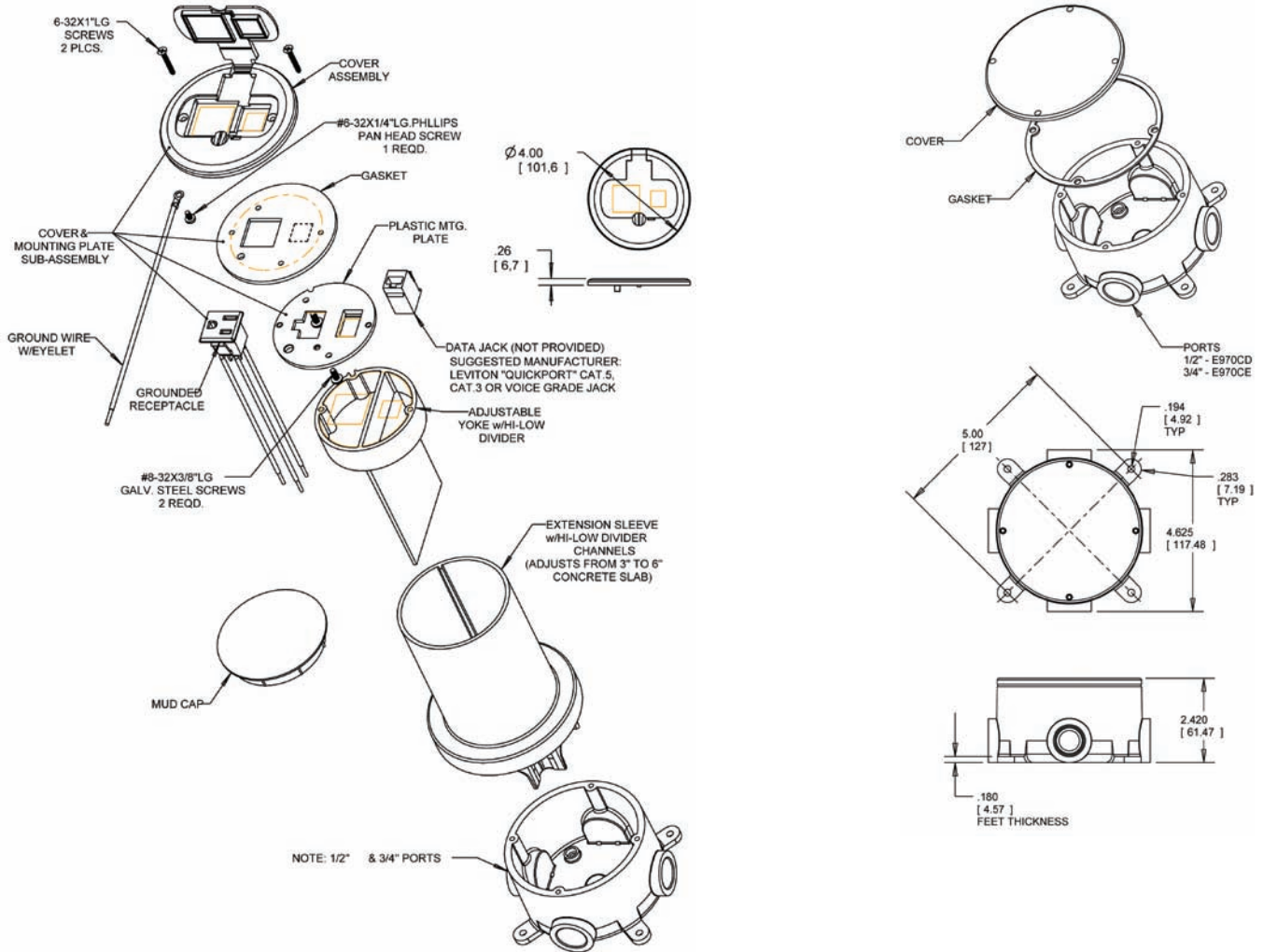

Single Receptacle (Larger Chamber)			Data Jack (Smaller Chamber)		
Depth	Material Fill (ml)	Volume (cu. in.)	Depth	Material Fill (ml)	Volume (cu. in.)
3"	133	8.109	3"	93	5.67
4"	182	11.09	4"	145	8.84
5"	216	13.17	5"	200	12.19
6"	283	17.25	6"	247	15.06

Carlon®

LAMSON & SESSIONS

In USA, contact:

25701 Science Park Drive • Cleveland, Ohio 44122

1-800-3-CARLON (1-800-322-7566) • In Ohio, (216) 464-3400

Fax: (216) 766-6444

TDD/Hearing Impaired Access (216) 831-5918

www.carlon.com

7F95 5M SP 2/07
© Lamson & Sessions 2007

In Canada, contact:

Lamson & Sessions Ltd.

121 Watline Avenue

Mississauga, ON • Canada L4Z 1P2

(905) 755-1262 • (888) 269-9902

Fax: (905) 755-1265 • (888) 269-8622