

Carlton® Flexible Raceway Systems

Plenum-Gard®

Riser-Gard®

*Hal-Free
Riser-Gard®*

*General
Purpose*





FT-6 Rated

Plenum-Gard is a UL Listed non-metallic corrugated flexible conduit for use in Plenum, Riser and General Purpose applications.

Plenum-Gard is manufactured from PVDF resin, which is extremely durable and resistant to abrasion and mechanical damage before/after cable installation.

Plenum-Gard is listed to UL 2024 in accordance with the National Electrical Code for Plenum, Riser, General Purpose, and other cabling optical fiber /telecommunication applications as defined in Articles 725, 770, 800 and 820.

Important: Installed cables must be plenum rated and the UL Listing must be printed on the product. Abandoned cables MUST be removed (Reference NEC).

Technical Info:

UL Standard 2024	Value
Maximum Flame Propagation	5 ft.
Max. Peak Optical Smoke Density	0.5
Max. Average Optical Smoke Density	0.15



Applications: Plenum, Riser, and General Purpose

- Storage -4°F to 158°F
- Handling -4°F to 104°F
- No UV protection (not suitable for outdoor use)
- Do NOT store outside

Standard Stock – Reels

	Color	Part No.	Min. Pull Tape	Reel Size (F x W)	Reel Type	Reel Length	Wt. (lbs.)	Wt. per 100 ft. (lbs.)
3/4"	Orange	CE4X1-1000	Empty	36" x 24"	W	1000	35	8
	Orange	CE4X1-1000S	Empty	36" x 24"	W	1000	35	8
1"	Orange	CF4X1C-500	900 lb.	36" x 24"	W	500	35	10
	Orange	CF4X1C-1000	900 lb.	48" x 32"	W	1000	90	10
	Orange	CF4X1C-1500	900 lb.	48" x 32"	W	1500	90	10
	Orange	CF4X1C-5200	900 lb.	66" x 41"	W	5200	265	10
	Orange	CF4X1C-6500	900 lb.	72" x 41"	W	6500	302	10
	Orange	CF4X1C-8000	900 lb.	82" x 41"	W	8000	375	10
1 1/4"	Orange	CG4X1C-500	900 lb.	36" x 24"	W	500	35	16
	Orange	CG4X1C-900	900 lb.	48" x 32"	W	900	90	16
	Orange	CG4X1C-1600	900 lb.	48" x 46"	W	1600	105	16
	Orange	CG4X1C-3200	900 lb.	66" x 41"	W	3200	265	16
	Orange	CG4X1C-6500	900 lb.	96" x 41"	W	6500	700	16
	Orange	CG4X1-900S	Empty	48" x 32"	W	900	90	16
1 1/2"	Orange	CH4X1C-350	900 lb.	48" x 32"	W	350	90	20
	Orange	CH4X1C-1200	900 lb.	48" x 46"	W	1200	105	20
	Orange	CH4X1C-4000	900 lb.	82" x 41"	W	4000	375	20
2"	Orange	CJ4X1C-225	900 lb.	48" x 32"	W	225	90	23
	Orange	CJ4X1C-700	900 lb.	48" x 46"	W	700	105	23
	Orange	CJ4X1C-2000	900 lb.	82" x 41"	W	2000	375	23
	Orange	CJ4X1C-2800	900 lb.	82" x 41"	W	2800	375	23

W = Wood

Features:

- For use in Plenum areas per Articles 725, 770, 800 and 820.
- Sizes 1/2" through 2"
- Pre-installed pull tape available in sizes 1/2" through 2"
- Outside Diameters meet IPS Dimensions
- UL Listed raceway meeting UL 2024
- Footage sequentially marked
- Single peak design

Standard Stock – Coils

	Color	Part No.	Pull Tape	Coil Length (ft.)	Wt. per 100 ft. (lbs.)
3/4"	Orange	CE4X1-350*	Empty	350	8
	Orange	CF4X1C-100*	900 lb.	100	10
1"	Orange	CF4X1C-250*	900 lb.	250	10
	Orange	CF4X1-250	Empty	250	10
	Orange	CF4X1-250S*	Empty	250	10
1 1/4"	Orange	CG4X1C-200*	900 lb.	200	16
1 1/2"	Orange	CH4X1C-150*	900 lb.	150	20
2"	Orange	CJ4X1C-100*	900 lb.	100	23

* Overnight Shippable

Specifications

Size	I.D. Min. Ref.	Min. O.D.	Max. O.D.	Min. Bend Radius
1/2"	.60	.815	.835	2"
3/4"	.74	1.025	1.045	2"
1"	1.00	1.292	1.312	3"
1 1/4"	1.35	1.630	1.650	3"
1 1/2"	1.50	1.868	1.888	4"
2"	2.00	2.329	2.349	4"

Custom Orders

How to Build a Part Number						
Position 1 Product	Position 2 Size	Position 3 Configuration	Position 4 Wall	Position 5 Color	Position 6 Pull Line	Position 7 Length
C = Plenum-Gard	D = 1/2" E = 3/4" F = 1" G = 1 1/4" H = 1 1/2" J = 2"	4 = Corrugated	X = Standard	1 = Orange 2 = Black 3 = Gray 4 = White 5 = Blue 7 = Yellow 8 = Red	C = 900 lb. Tape	Example -1000 = Feet -1000S = 1000 Feet Split

- Custom Orders are not returnable
- Custom lengths are available in minimum order quantities of 1000 ft.
- Custom color runs are available in minimum order quantities of 10,000 ft.

Options:

- Color: Black, Blue, Gray, Red, White and Yellow
- Two, three, or four way parallel
- Split Duct
- Custom print line



Riser-Gard is a nonmetallic flexible raceway for use in Riser and General Purpose applications. Riser-Gard is UL Listed and is available with tape pre-installed.

Riser-Gard is listed to UL 2024 Standard for Riser Applications or optical fiber/communications raceways.

Riser-Gard is listed to UL 2024 in accordance with the National Electrical Code per Articles 725, 770, 800 and 820 for Riser, General Purpose, and other cabling optical fiber/telecommunication applications.

Riser-Gard is suitable for use in vertical runs in a shaft or between floors, as well as areas other than the plenum.

Important: Installed cables must be of suitable rating for the application.

Applications: Riser and General Purpose

Technical Info:

UL Listed to 2024	Test Method	Maximum Value
Maximum Flame Propagation	UL 2024	6.0 ft.
Maximum Air Temperature at 12 ft.	UL 2024	372°F

- Storage -4°F to 158°F
- Handling -4°F to 104°F
- No UV protection (not suitable for outdoor use)
- Do NOT store outside

Standard Stock – Reels

	Color	Part No.	Pull Tape	Reel Size (F x W)	Reel Type	Reel Length	Reel Wt. (lbs.)	Product Wt. per 100 ft. (lbs.)
3/4"	Orange	DE4X1-1000	Empty	36" x 24"	W	1000	35	9
	Orange	DF4X1C-500R	900 lb.	42" x 24"	W	500	50	14
	Orange	DF4X1C-1000	900 lb.	48" x 32"	W	1000	90	14
	Orange	DF4X1C-1500	900 lb.	48" x 32"	W	1500	90	14
1"	Orange	DF4X1C-2700	900 lb.	48" x 46"	W	2700	105	14
	Orange	DF4X1C-5200	900 lb.	66" x 41"	W	5200	265	14
	Orange	DF4X1C-6500	900 lb.	72" x 41"	W	6500	302	14
	Orange	DF4X1C-7000	900 lb.	72" x 45"	S	7000	148	14
	Orange	DF4X1C-9400	900 lb.	84" x 45"	S	9400	199	14
1 1/4"	Orange	DG4X1C-900	900 lb.	48" x 32"	W	900	90	17
	Orange	DG4X1C-500R	900 lb.	42" x 24"	W	500	50	17
	Orange	DG4X1C-1500	900 lb.	48" x 46"	W	1500	105	17
	Orange	DG4X1C-1600	900 lb.	48" x 46"	W	1600	105	17
	Orange	DG4X1C-3200	900 lb.	66" x 41"	W	3200	265	17
	Orange	DG4X1C-4500	900 lb.	72" x 45"	S	4500	148	17
	Orange	DG4X1C-5600	900 lb.	84" x 46"	W	5600	600	17
	Orange	DG4X1C-6500	900 lb.	96" x 45"	S	6500	220	17
1 1/2"	Orange	DH4X1C-1200	900 lb.	48" x 46"	W	1200	105	22
	Orange	DH4X1C-4000	900 lb.	82" x 45"	S	4000	193	22
	Orange	DH4X1C-4500	900 lb.	84" x 45"	S	4500	199	22
2"	Orange	DJ4X1C-700	900 lb.	48" x 46"	W	700	105	26
	Orange	DJ4X1C-2000	900 lb.	82" x 41"	W	2000	375	26
	Orange	DJ4X1C-2800	900 lb.	84" x 45"	S	2800	199	26

W = Wood, S = Steel

Features:

- For use in Riser and General Purpose areas per Articles 725, 770, 800 and 820 of the NEC.
- Riser-Gard is also suitable for direct burial. Not approved for exposed applications.
NOTE: UL has not evaluated Riser-Gard for this application.
- UL Listed Raceway meeting UL 2024
- Available in sizes 3/4" through 2"
- Pull tape can be factory pre-installed in 1" through 2"
- Outside Diameters meet IPS Dimensions
- Footage sequentially marked

Standard Stock – Coils

	Color	Part No.	Pull Tape	Coil Length (ft.)	Product Wt. per 100 ft. (lbs.)
3/4"	Orange	DE4X1-350*	Empty	350	9
	Orange	DF4X1C-250*	900 lb.	250	14
1"	Orange	DF4X1C-500	900 lb.	500	14
	Orange	DF4X1-250S*	Empty	250	14
1 1/4"	Orange	DG4X1-200	Empty	200	17
	Orange	DG4X1C-200*	900 lb.	200	17
	Orange	DG4X1C-500	900 lb.	500	17
	Orange	DG4X1-200S*	Empty	200	17
1 1/2"	Orange	DH4X1C-150*	900 lb.	150	22
2"	Orange	DJ4X1C-100*	900 lb.	100	26

* Overnight Shippable

Specifications

Size	I.D. Min. Ref.	Min. O.D.	Max. O.D.	Min. Bend Radius
3/4"	.74	1.025	1.075	6"
1"	.98	1.290	1.340	6"
1 1/4"	1.31	1.640	1.690	7"
1 1/2"	1.54	1.880	1.930	8 1/4"
2"	2.00	2.350	2.400	9 1/2"

Custom Orders

How to Build a Part Number						
Position 1 Product	Position 2 Size	Position 3 Configuration	Position 4 Wall	Position 5 Color	Position 6 Pull Line	Position 7 Length
D = Riser-Gard	E = 3/4" F = 1" G = 1 1/4" H = 1 1/2" J = 2"	4 = Corrugated	X = Standard	1 = Orange 2 = Black 3 = Gray 4 = White 5 = Blue 7 = Yellow 8 = Red	C = 900 lb. Tape	Example -1000 = Feet -1000S = 1000 Feet Split

- Custom Orders are not returnable
- Custom lengths are available in minimum order quantities of 1000 ft.
- Custom color runs are available in minimum order quantities of 10,000 ft.

Options:

- Color: Black, Blue, Gray, Red, White and Yellow
- Two, three, or four way parallel
- Split Duct
- Custom print line



Hal-Free Riser-Gard is a halogen free nonmetallic flexible raceway for use in riser and general purpose applications. In the event of a fire, this product will not release halogen elements into the air, which makes it ideal for applications in tunnels, laboratories and high-tech environments.

Hal-Free Riser-Gard is listed to UL 2024 in accordance with NEC Articles 725, 770, 800 and 820.

Custom lengths and split ducts are available upon request. Hal-Free Riser-Gard is available in white only.

Applications: Riser and General Purpose

Features:

- Free from halogen elements
- Compliant with NEC Articles 725, 770, 800 and 820
- Available in sizes 1" through 2"
- Available in white only
- Sequentially marked footage

Technical Info:

UL Listed to 2024	Test Method	Maximum Value
Maximum Flame Propagation	UL 2024	3'6"
Maximum Air Temperature	UL 2024	387°F

- Storage and Handling -4°F to 150°F
- No UV protection (not suitable for outdoor use)
- Do NOT store outside

Standard Stock – Reels

	Color	Part No.	Nom. I.D.	Nom. O.D.	Pull Tape	Reel Size	Reel Type	Reel Length (feet)	Reel Weight (lbs.)	Wt. per 100 ft. (lbs.)
1"	White	HF4X4C-5000	1.049	1.365	900 lb.	72" x 41"	W	5000	302	7.3
1 1/4"	White	HG4X4C-4000	1.250	1.550	900 lb.	72" x 41"	W	4000	302	9.2
1 1/2"	White	HH4X4C-2000	1.500	1.850	900 lb.	66" x 41"	W	2000	265	12.0
2"	White	HJ4X4C-2000	2.000	2.425	900 lb.	82" x 41"	W	2000	375	20.8

W = Wood

Custom Orders

How to Build a Part Number						
Position 1 Product	Position 2 Size	Position 3 Configuration	Position 4 Wall	Position 5 Color	Position 6 Pull Line	Position 7 Length
H = Hal-Free Riser-Gard	F = 1" G = 1 1/4" H = 1 1/2" J = 2"	4 = Corrugated	X = Standard	4 = White	C = 900 lb. Tape	Example -1000 = Feet -1000S = 1000 Feet Split

- Custom orders not returnable
- Custom lengths available in minimum order quantities of 1000 ft.

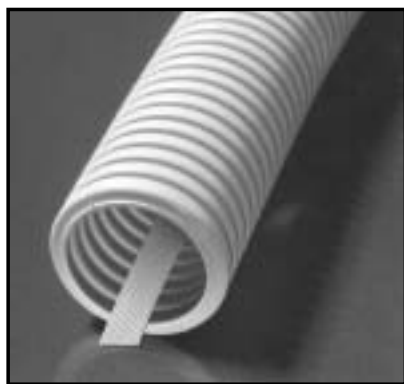

General Purpose is nonmetallic flexible raceway for use in General Purpose applications only. It is UL Listed and available with tape pre-installed.

General Purpose raceway is listed to UL 2024 in accordance with the National Electrical Code per Articles 725, 770, 800 and 820 for General Purpose and other cabling optical fiber/telecommunication applications.

Features:

- For use in General Purpose areas per Articles 725, 770, 800 and 820 of the NEC.
- Available in sizes 3/4" through 2"
- Pull tape can be factory pre-installed in 1" through 2"
- Outside Diameters meet IPS Dimensions
- Footage sequentially marked

Applications: General Purpose



Technical Info:

UL Listed to 2024	Test Method	Maximum Value
Maximum Flame Propagation	UL 2024	6.0 ft.
Maximum Air Temperature at 12 ft.	UL 2024	372°F

- Storage -4°F to 158°F
- Handling -4°F to 104°F
- No UV protection (not suitable for outdoor use)
- Do not store outside

Standard Stock – Reels

	Color	Part No.	I.D. Min. Ref.	Min. O.D.	Max. O.D.	Pull Tape	Min. Bend Radius	Reel Size (F x W)	Reel Type	Reel Length	Reel Wt. (lbs.)	Product Wt. per 100 ft. (lbs.)
1"	Orange	BF4X1B-8000	.98	1.29	1.34	1130 lb.	6"	82" x 41"	W	8000	375	14
1 1/4"	Orange	BG4X1B-5600	1.31	1.64	1.69	1130 lb.	7"	72" x 41"	W	5600	302	17
1 1/2"	Orange	BH4X1B-4500	1.54	1.88	1.93	1130 lb.	8 1/4"	82" x 41"	W	4500	375	22
2"	Orange	BJ4X1B-8000	2.00	2.35	2.40	1130 lb.	9 1/2"	82" x 41"	W	2000	375	26

W = Wood

Custom Orders

How to Build a Part Number						
Position 1 Product	Position 2 Size	Position 3 Configuration	Position 4 Wall	Position 5 Color	Position 6 Pull Line	Position 7 Length
B = General Purpose	F = 1" G = 1 1/4" H = 1 1/2" J = 2"	4 = Corrugated	X = Standard	1 = Orange 2 = Black 3 = Gray 4 = White 5 = Blue 7 = Yellow 8 = Red	B = 1130 lb. Tape	Example -1000 = Feet

- Custom Orders are not returnable
- Custom lengths are available in minimum order quantities of 1000 ft.
- Custom color runs are available in minimum order quantities of 10,000 ft.

Options:

- Color: Black, Blue, Gray, Red, White and Yellow
- Two, three, or four way parallel
- Split Duct
- Custom print line

Flexible Raceway Accessories

Nonmetallic Adapters & Couplings

- For use with Riser-Gard® and General Purpose



Couplings



Part. No.	Size	Color	Standard Carton Quantity	Standard Carton Weight (lbs.)
SCA240E	3/4"	Orange	25	.783
SCA240F	1"	Orange	20	.972

Threaded Adapters



Part. No.	Size	Color	Standard Carton Quantity	Standard Carton Weight (lbs.)
SCA243E	3/4"	Orange	100	2.30
SCA243F	1"	Orange	50	2.00

Snap-In Adapters



Part. No.	Size	Color	Standard Carton Quantity	Standard Carton Weight (lbs.)
SCA253E	3/4"	Orange	100	2.90
SCA253F	1"	Orange	50	2.30

Nonmetallic Adapters & Couplings

- For use with Plenum-Gard®



Couplings



Part. No.	Size	Color	Standard Carton Quantity	Standard Carton Weight (lbs.)
A340F	1"	Orange	50	2.50

Couplings



Part. No.	Size	Color	Standard Carton Quantity	Standard Carton Weight (lbs.)
A343F	1"	Orange	50	1.55

Couplings



Part. No.	Size	Color	Standard Carton Quantity	Standard Carton Weight (lbs.)
A353F	1"	Orange	50	3.00



Except where noted by ▶

Nonmetallic Adapters and Couplings

- For use with Riser-Gard® and General Purpose

Male Terminal Adapters



For adapting nonmetallic conduits to boxes, threaded fittings, metallic systems. Male threads on one end, socket end on other.

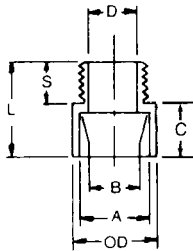

Part No.	Size	Std. Ctn. Qty.	Color	A	B Typical	Min. D	Max. OD	C	T Typical	L	Std. Ctn. Wt. (lbs.)
E943E	3/4"	125	Gray	1.064	1.046	.800	1 11/32	3/4"	9/16"	1 3/8"	3.5
E943F	1"	50	Gray	1.330	1.310	1.018	1 5/8"	1"	11/16"	1 25/32"	3
E943G	1 1/4"	50	Gray	1.677	1.655	1.332	2 1/32"	1"	3/4"	1 15/16"	4
E943H	1 1/2"	25	Gray	1.918	1.894	1.566	2 5/32"	1 3/16"	3/4"	2 1/16"	2.5
E943J	2"	50	Gray	2.393	2.369	2.000	2 21/32"	1 3/16"	3/4"	2 1/8"	7
SCE943G	1 1/4"	50	Orange	1.677	1.655	1.332	2 1/32"	1"	3/4"	1 15/16"	4
SCE943H	1 1/2"	25	Orange	1.918	1.894	1.566	2 5/32"	1 3/16"	3/4"	2 1/16"	2.5
SCE943J	2"	50	Orange	2.393	2.369	2.000	2 21/32"	1 3/16"	3/4"	2 1/8"	7

Standard Couplings

All socket fittings should be attached Using Carlon solvent cement. Using Carlon fittings with Carlon nonmetallic conduit insures system integrity.



Socket type for joining nonmetallic conduit.

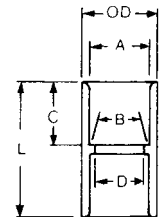

Part No.	Size	Std. Ctn. Qty.	Color	A	B	Min. D	Max. OD	C	L	Std. Ctn. Wt. (lbs.)
E940E	3/4"	100	Gray	1.064	1.046	.840	1 5/16"	3/4"	1 5/8"	4.4
E940F	1"	50	Gray	1.330	1.310	1.210	1 5/8"	1 1/16"	2"	3.5
E940G	1 1/4"	30	Gray	1.677	1.655	1.535	1 63/64"	1"	2 1/8"	3.5
E940H	1 1/2"	25	Gray	1.918	1.894	1.755	2 15/64"	1 1/8"	2 3/8"	3.9
E940J	2"	30	Gray	2.393	2.369	2.190	2 47/64"	1 3/16"	2 1/2"	5.25
SCE940G	1 1/4"	30	Orange	1.677	1.655	1.535	1 63/64"	1"	2 1/8"	3.5
SCE940H	1 1/2"	25	Orange	1.918	1.894	1.755	2 15/64"	1 1/8"	2 3/8"	3.9
SCE940J	2"	30	Orange	2.393	2.369	2.190	2 47/64"	1 3/16"	2 1/2"	5.25

Metallic Adapters and Couplings

Universal Aluminum Couplings

- For use with Plenum-Gard®, Riser-Gard®, Hal-Free Riser-Gard®, and General Purpose

Self-threading, which draws each end of the conduit into the center of the coupler.



Part No.	Size	Duct O.D. Range	Std. Ctn. Qty.	Std. Ctn. Wt. (lbs.)
▶ P75	3/4"	.91 – 1.08	10	12
▶ P100	1"	1.21 – 1.41	100	25
▶ P125	1 1/4"	1.44 – 1.68	100	28
▶ P150CPLR	1 1/2"	1.80 – 2.02	100	35
▶ P200	2"	2.31 – 2.48	50	19



Terminating Connector

- For use with Plenum-Gard® and Hal-Free Riser-Gard®

Part No.	Size	Nom. O.D. Range	Std. Ctn. Qty.	Std. Ctn. Wt.
TC100	1"	.91 – 1.08	12	50
TC125	1 1/4"	1.495 – 1.70	12	52
TC150	1 1/2"	1.80 – 2.00	12	56
TC200	2"	2.31 – 2.52	12	58

Metallic Terminal Adapter

- For use with Plenum-Gard®

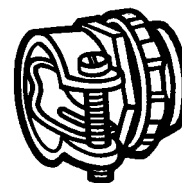

Part No.	Size	Std. Ctn. Qty.	Std. Ctn. Wt. (lbs.)
▶ E147E	3/4"	1	.7
▶ E147F	1"	25	1.5

Washers Flat Sealing Washer

Where a waterproof termination is required into any enclosure (metallic or nonmetallic), install the neoprene washer over the threads of a terminal adapter before inserting into the enclosure. Use a standard locknut or threaded bushing to secure the assembly.



Part No.	Size	Std. Ctn. Qty.	Std. Ctn. Wt. (lbs.)
▶ E943EW	3/4"	125	.45
▶ E943FW	1"	100	.46
▶ E943GW	1 1/4"	50	.44
▶ E943HW	1 1/2"	50	.45
▶ E943JW	2"	25	.42

Low Voltage Boxes & Brackets

Dual Voltage Box/Bracket*



SC200DV

Part No.	Size	Volume	Std. Ctn. Qty.	Std. Ctn. Wt. (lbs.)
SC200DV	1-Gang	20.5 cu. in.	16	6.4

*U.S. Patent D463,376



Low Voltage Add-On Bracket*



SC100SC

Part No.	Size	Std. Ctn. Qty.	Std. Ctn. Wt. (lbs.)
SC100SC	1-Gang	24	2.3

*U.S. Patent D459,312
U.S. Patent 6,710,245



Low Voltage Adjustable Brackets*

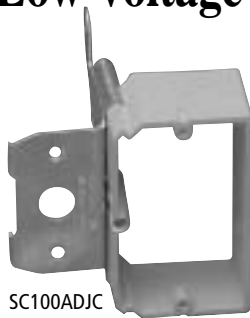

SC100ADJC

Part No.	Size	Std. Ctn. Qty.	Std. Ctn. Wt. (lbs.)
SC100ADJC	1-Gang	24	7.5
SC200ADJC	2-Gang	20	6.9

*U.S. Patent 5,289,934



Low Voltage Brackets*



SC100A



SC200A

Part No.	Size	Std. Ctn. Qty.	Std. Ctn. Wt. (lbs.)
SC100A	1-Gang	24	5.3
SC200A (3/4" Resi-Rings)	2-Gang	24	7.7

*U.S. Patent D457,140
D462,664

*©Lamson & Sessions



NEW

Mud Box Assemblies



Except where noted by ►

Carlson Mud Box Assemblies are available in five unique styles...blank, ceiling ring, one-gang, two-gang and 4 square. All Mud Box Assemblies are manufactured out of polycarbonate material to provide extra strength and durability, are concrete tight, and have twelve integral connectors...two-1", six-3/4", and four-1/2". Using our new ENT Reducers, this product will meet ANY jobsite application.

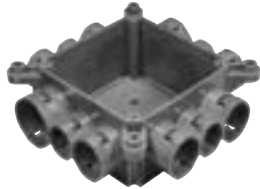

Mud Box Base with Blank Cover

Part. No.	Size	Std. Ctn. Qty.	Std. Ctn. Wt. lbs.
► A863BC	Mud Box w/ Blank Cover	24	12.3

Patent Pending

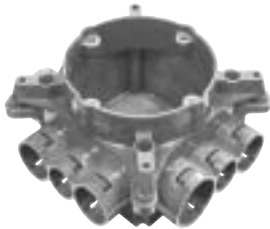

Mud Box with Ceiling Ring

- Threaded brass inserts for fan (#10-32 screws) and fixture (#8-32 screws) mountings
- Listed for fixture support up to 50 lbs.
- Listed for ceiling fans up to 35 lbs.

Part. No.	Size	Std. Ctn. Qty.	Std. Ctn. Wt. lbs.
► A863CF	Mud Box w/ Ceiling Ring	24	15.5
A863CFG	Mud Box w/ Ceiling Ring & Ground Lug	24	16.1

Patent Pending

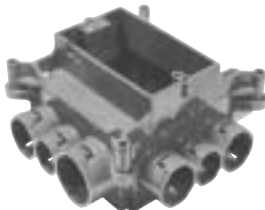

Mud Box with One-Gang Ring

Part. No.	Size	Std. Ctn. Qty.	Std. Ctn. Wt. lbs.
► A863S	Mud Box w/ One-Gang Ring	24	16.8
A863SG	Mud Box w/ One-Gang Ring & Ground Lug	24	16.2

Patent Pending

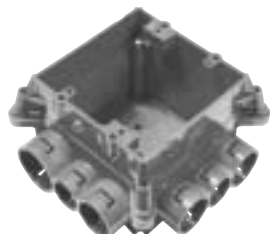

Mud Box with Two-Gang Ring

Part. No.	Size	Std. Ctn. Qty.	Std. Ctn. Wt. lbs.
► A863D	Mud Box w/ Two-Gang Ring	24	15.8
A863DG	Mud Box w/ Two-Gang Ring & Ground Lug	24	16.6

Patent Pending

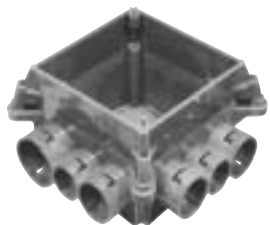

Mud Box with 4 Square Ring

- 4 Square Ring not for luminaries.

Part. No.	Size	Std. Ctn. Qty.	Std. Ctn. Wt. lbs.
► A863-4SQ	Mud Box w/ 4 Inch Square Ring	24	15.2

Patent Pending

2 1/2" & 4" Mud Boxes with Covers

- For use with Riser-Gard® and General Purpose



Base Rings

Listed for use with ceiling fans up to 35 lbs. and for fixture support up to 50 lbs.

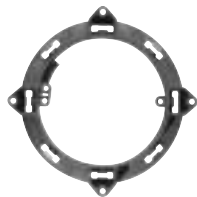

Part. No.	Description	Standard Carton Quantity	Standard Carton Weight (lbs.)
A861	Without ground lug	10	2.5
CA861G	With ground lug	10	2.0

Covers



Part. No.	Description	Standard Carton Quantity	Standard Carton Weight (lbs.)
A862D	2 1/2" Deep (1/2" KO's)	10	2.5
A862E	2 1/2" Deep (3/4" KO's)	10	2.1
A864D	4" Deep (1/2" KO's)	10	2.9
A864E	4" Deep (3/4" KO's)	10	2.9
A864F	4" Deep (1" KO's)	10	3.0

Quick Connect Outlet and Switch Boxes

- For use with Riser-Gard® and General Purpose
- Suitable for masonry walls
- Meets NEMA OS-2



Single Gang – 16 cu. in.



Part. No.	Description	Standard Carton Quantity	Standard Carton Weight (lbs.)
A58381D	3 x 2 1/4 x 3 (1/2" KO's)	25	4.6
A58381E	3 x 2 1/4 x 3 (3/4" KO's)	25	4.6

Two Gang – 20 cu. in.



Part. No.	Description	Standard Carton Quantity	Standard Carton Weight (lbs.)
A52151D	4 x 4 x 1 1/2 (1/2" KO's)	100	22.6
A52151E	4 x 4 x 1 1/2 (3/4" KO's)	100	22.6
A521DE	4 x 4 x 1 1/2 (1/2" & 3/4" KO's)	100	22.6

Two Gang – 30.3 cu. in.



Part. No.	Description	Standard Carton Quantity	Standard Carton Weight (lbs.)
A52171D	4 x 4 x 2 3/8 (1/2" KO's)	25	7.6
A52171E	4 x 4 x 2 3/8 (3/4" KO's)	25	7.6
A5217DE	4 x 4 x 2 3/8 (1/2" & 3/4" KO's)	25	7.6

ENT Box with Adapters

- For use with Riser-Gard® and General Purpose



LISTED

E42728 Except where noted by ►



Two Gang – 24.75 cu. in. ENT Box with Adapters

Part. No.	Description	Standard Carton Quantity	Standard Carton Weight (lbs.)
A5329DE	4 x 4 x 1 3/4 (1/2" & 3/4" KO's)	50	14.8

Box Back Wall Support



Part. No.	Description	Standard Carton Quantity	Standard Carton Weight (lbs.)
► A540DS	For use with 1/2" Knockout	100	2.1

ENT Box Extenders

- For use with Riser-Gard® and General Purpose



LISTED

E42728

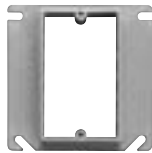

Single Gang

Part. No.	Rise	Cu. in.	Standard Carton Quantity	Standard Carton Weight (lbs.)
A410	1/2"	3.5	100	7.7
A411	5/8"	4.2	50	4.6
A412	3/4"	5.0	50	5.1
A413	1"	6.6	40	5
A414	1 1/4"	8.1	30	4.4



Two Gang

Part. No.	Rise	Cu. in.	Standard Carton Quantity	Standard Carton Weight (lbs.)
A400	Blank	-	100	7.7
A420	1/2"	6.1	75	5.0
A421	5/8"	7.4	50	4.2
A422	3/4"	8.8	50	4.8

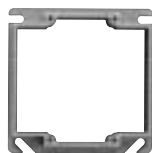

Round Covers for Octagon Ceiling Boxes

- For use with Riser-Gard® and General Purpose



LISTED

E42728

Round Plaster Rings

- Suitable for fixture support



Part. No.	Rise	Cu. in.	Standard Carton Quantity	Standard Carton Weight (lbs.)
A471	1/2"	3.2	100	3.3
A472	3/4"	4.0	100	3.7

Round Blank Covers



Part. No.	Rise	Cu. in.	Standard Carton Quantity	Standard Carton Weight (lbs.)
E460R-CAR	Blank	-	35	2.2
A470D	Blank with 1/2" KO	-	100	4.7

Quick Connect 4" Octagon Ceiling Boxes

- For use with Riser-Gard® and General Purpose
- Carlon ceiling boxes and round plaster rings are produced from a special high heat resistant engineered plastic material developed specifically for fixture support.
- Listed for fixture support up to 50 lbs.



LISTED
E42728

Except where
noted by ►

Ceiling Box – 20.5 cu. in.



Part. No.	Description	Standard Carton Quantity	Standard Carton Weight (lbs.)
A615D	4 - 2 ¹ / ₈ " Deep (1/2" KO's)	50	6.4
A615E	4 - 2 ¹ / ₈ " Deep (3/4" KO's)	50	6.4
A615DE	4 - 2 ¹ / ₈ " Deep (1/2" & 3/4" KO's)	50	6.4



Ceiling Box with J Mount – 20.5 cu. in.

Part. No.	Description	Standard Carton Quantity	Standard Carton Weight (lbs.)
A615DJ	4 - 2 ¹ / ₈ " Deep (1/2" KO's)	50	18.7



Ceiling Box with L Bracket – 20.5 cu. in.

Part. No.	Description	Standard Carton Quantity	Standard Carton Weight (lbs.)
A615DL	4 - 2 ¹ / ₈ " Deep (1/2" KO's)	50	6.4



Ceiling Box with Adjustable Hanger Bar – 20.5 cu. in.

Adjust from 14¹/₄" to 23¹/₄"

Part. No.	Description	Standard Carton Quantity	Standard Carton Weight (lbs.)
A615DH	4 - 2 ¹ / ₈ " Deep (1/2" KO's)	25	13.6

PVC Conduit Cutters

Small Cutter



For fast, smooth field cuts of 1/2" through 1" Riser-Gard® and Plenum-Gard.

Part No.	Size	Std. Ctn. Qty.
► CC120B	8"	10

Medium Cutter



Hand held cutter makes fast square, smooth field cuts on conduit from 1/2" through 1¹/₄". Produces burr-free cut with no shavings. Fits into pocket or pouch.

Part No.	Size	Std. Ctn. Qty.
► CC125	9"	12

Large Cutter



For clean cuts of conduit 1/2" through 2".

Part No.	Size	Std. Ctn. Qty.
► CC122	17 ¹ / ₂ "	1

Tape Prelubricated, woven polyester tape made from low friction, high abrasion resistant yarns providing a low coefficient of friction. Tape is printed with sequential footage markings for accurate measurements.



Part. No.	Size	Tensile Strength	Reel Lengths
TL14505	1/2"	1250 lbs.	5,000 ft.
TL14510	1/2"	1250 lbs.	10,000 ft.
TL38203	5/8"	1800 lbs.	3,000 ft.
TL38265	5/8"	1800 lbs.	6,500 ft.
TL38210	5/8"	1800 lbs.	10,000 ft.

Other ropes and tapes are available. Consult your sales service location for additional information.

Carlon® Cement

(MSDS sheets available at www.carlon.com)

*Meets ASTM D2564

Medium Bodied Clear PVC Solvent Cement with dauber*



Part No.	Size	Std. Ctn. Qty.
VC9964	1/2 Pint	10
VC9963	Pint	24
VC9962	Quart	12
VC9961P	Gallon	6

Recommended pipe application and sizes

Recommended for all grades and types of Carlon PVC conduit, duct, wireway and fittings, except Flex-Plus® Blue™ ENT (Electrical Nonmetallic Tubing.)
Up through 6" diameter.

Set-up time (Evaporation Rate)

10°-30°F Not recommended
30°-50°F 5-6 minutes
50°-70°F 3-4 minutes
70°-90°F 1-2 minutes

Recommended installation temperature

40° to 100°F

Lap Shear @ 73°F

2 hrs. 350 psi
16 hrs. 800 psi
72 hrs. 1,500 psi

Viscosity at 75° as manufactured

500-900 cps

All-Weather "Quick-Set" Clear Solvent Cement with dauber*



Part No.	Size	Std. Ctn. Qty.
VC9984	1/2 Pint	10
VC9983	Pint	24
VC9982	Quart	12
VC9981P	Gallon	6

Recommended for all grades and types of Carlon PVC conduit, duct, wireway and fittings, except Flex-Plus® Blue™ ENT (Electrical Nonmetallic Tubing.)
Up through 6" diameter.

10°-30°F 4-5 minutes
30°-50°F 3-4 minutes
50°-70°F 1-2 minutes
70°-90°F 1/2-1 1/2 minutes

-5° to 100°F

2 hrs. 350 psi
16 hrs. 800 psi
72 hrs. 1,500 psi

400-700 cps

Low VOC Gray PVC Solvent Cement with dauber*



Part No.	Size	Std. Ctn. Qty.
VC9LV4	1/2 Pint	10
VC9LV3	Pint	24
VC9LV2	Quart	12

Recommended for all grades and types of Carlon PVC conduit, duct, wireway and fittings, except Flex-Plus® Blue™ ENT (Electrical Nonmetallic Tubing.)
Up through 6" diameter.
VOC emission of 490 grams/liter per the Bay and South Coast test method.

10°-30°F Not recommended
30°-50°F 5-6 minutes
50°-70°F 3-4 minutes
70°-90°F 1-2 minutes

40° to 100°F

2 hrs. 350 psi
16 hrs. 800 psi
72 hrs. 1,500 psi

500-900 cps

Carlson® Innerduct Guide

WHERE IS INNERDUCT BEING USED?

INSIDE THE BUILDING

Plenum

- Must be UL Listed
- Plenum cable must be installed
- Color: Industry standard=orange
- Pull tape pre-installed in sizes 1/2" through 2"
- Plenum-Gard® product numbers:
 - 1/2" CD4X1C
 - 3/4" CE4X1C
 - 1" CF4X1C
 - 1 1/4" CG4X1C
 - 1 1/2" CH4X1C
 - 2" CJ4X1C

General Purpose & Riser

- Must be UL Listed
- Riser rated cable must be used in riser applications
- Color: Industry standard=orange
- Riser-Gard® product numbers:
 - 3/4" DE4X1C
 - 1" DF4X1C
 - 1 1/4" DG4X1C
 - 1 1/4" DH4X1C
 - 2" DJ4X1C
- General Purpose product numbers:
 - 1" BF4X1B
 - 1 1/4" BG4X1B
 - 1 1/4" BH4X1B
 - 2" BJ4X1B

Note:

- HDPE innerduct will not meet code

OUTSIDE THE BUILDING

Pulled into a Conduit

- HDPE True sized duct recommended 1.00" ID or 1.25" ID
- Corrugated (Riser-Gard and HDPE) duct for newer conduit runs & shorter distance pulls
- HDPE Solidwall for older conduit runs & longer distance pulls

Plowed or Trenched

- HDPE SDR sized duct recommended (1 1/4" or larger)
- HDPE SDR 13 wall thickness for non-rocky soil conditions
- HDPE SDR 11 wall thickness for rocky conditions
- Riser-Gard approved for direct bury applications but **NOT** exposed applications

NOTE:

- Aerial HDPE for exposed applications

Options

- Color
- Striping
- Factory installed pull lines
- Segmented or paralleled reels
- Pre-lubricated duct

Specifying and installing UL Listed innerducts with the anticipation of future upgrades provides the building owner with a low cost solution for the removal of abandoned cables.